



# Fitting Instructions

TOWBAR SY11A  
for Ssangyong Rexton  
2006 -

## MATERIALS

A	1	Tow bar Mainframe with European facing 94/20/EC – A50-1
B	1	Right Side Bush Assembly
C	1	Left Side Bush Assembly
D	2	Captive Plate Assembly
E	1	Chassis Side Arm Left
F	1	Chassis Side Arm Right
G	1	Tow ball Neck
H	2	M14 x 130 x 2.00 Bolts, 2 Large Flat Washers (40mm O.D), 2 lock Washers
I	2	M14 x 50 x 2.00 Bolts, 2 Large Flat Washers (40mm O.D), 2 lock Washers
J	6	M14 x 50 x 2.0 Bolts, 10 flat washers (28 O.D), 6 M14 lock Washers, 4 Nyloc nuts.
K	3	M12 x 100 x 1.75 Bolts, 6 flat Washers (24 O.D), 3 Nyloc Nuts, 6 bolt caps
L	1	ZEP 3 Electrical Plate
N	1	Bush 25MM OD x 39mm Long
O	2	M6 X20X1.00 Bolts, 2 Nuts, 4 flat washers 20 O.D. Underside of Cross Bar.
P	3	4.8mm x 250mm Cable Ties
CB	2	M16 X 50X2.00 Bolts, 2 Nuts, 4 lock washers, 2 bolt caps.

**Note:** This towbar must be used with either a Witter Towball (part number Z12) or Class A50-1 or A50-X towball dimensionally Conforming to A50-1 with a 'D' and 'S' value greater than or equal to that of the towbar.

Please refer to the vehicle specification for the trailer weight and nose limits, which **must be observed**.

**Recommended torque settings:** M8 - 27Nm, M10 - 53 Nm, M12 - 95 Nm, M14 - 150 Nm, M16 - 214 Nm

## FITTING

1. Firstly remove the rear light clusters (**Open the tail gate and unscrew the x2 mounting screws either side of the clusters. Disconnect the cable and carefully pull clusters rearward**).
2. Remove the rear bumper (**Unscrew the x2 mounting bolts from the black mounting brackets, unscrew the x2 mounting screws in the top edge of the bumper, remove the plastic rivets in the top face of the bumper, remove the x2 mounting bolts from beneath the bumper and x7 screws in each of the wheel arches**). Ensure reversing sensor cables are disconnected if fitted
3. Remove the foam packing and the rear crash member (**x4 Bolts**) to open the ends of the chassis rails.
4. Slide Bush Assembly (**B & C**) into each of the open chassis rails, aligning with the existing vertical holes.
5. Loosely attach side arms (**E**) & (**F**) to the underside of the chassis rail using the 2 forward bolts for support (**I**).
6. Whilst keeping the two **forward** bolts loose (**I**), slide on to the top face of the chassis Plate (**D**) aligning the captive nut with the rearmost hole (**C & B**). Use the diagram below as reference.
7. Using Bolts H, thread the rearward fasteners through the side arms (**E**) & (**F**), through the chassis rail sandwiching all components. Ensuring the bush assemblies (**B&C**) are in place.
8. Loosely attach the Cross Bar (**A**) to the side arms (**E**) & (**F**) using Bolts (**J**). Note: Fitment will be eased if two people are used during this assembly. Use Thread lock on the captive Bolts.
9. Fully tighten fasteners (**H, I, J**) to their recommended torque settings once satisfied with tow bar positioning around the spare wheel carrier. (**Note:** Vehicles fitted with Reverse sensors, cable tie the loom around the bar ensuring significant clearance from the exhaust.)
10. Add Tow ball neck (**G**) to the Cross bar using 2 bolts (**K**), higher holes first. Add electrical bracket (**L**). On the lower hole, slot bush (**N**) into the bracket (**G**), aligning the third hole. Use remaining Bolt (**K**) and loosely tighten.
11. Cut Bumper as per diagram. (Tip: offer the bumper to the rear of the vehicle as a guide for cutting position.)
12. Remove the crash beam from the bumper and reattach the rear bumper and light clusters in reverse order to removal. (**Note: Reverse sensor loom will be required to be removed from crash beam, use cable ties to reattach loom to the cross bar**)
12. **For bumper support** attach the bumper lug to the cross tube brackets provided. Drill Plastic if necessary. Use M6 Bolts provided Bolts (**O**).
13. Attach the coupling packer and tow ball using the provided coupling bolts. (**CB**)
14. Ensure all fasteners have been tightened to their recommended torque setting. Use lock thread on any captive nuts.



W0001SY11A-FIT\$021103160000

## Visual

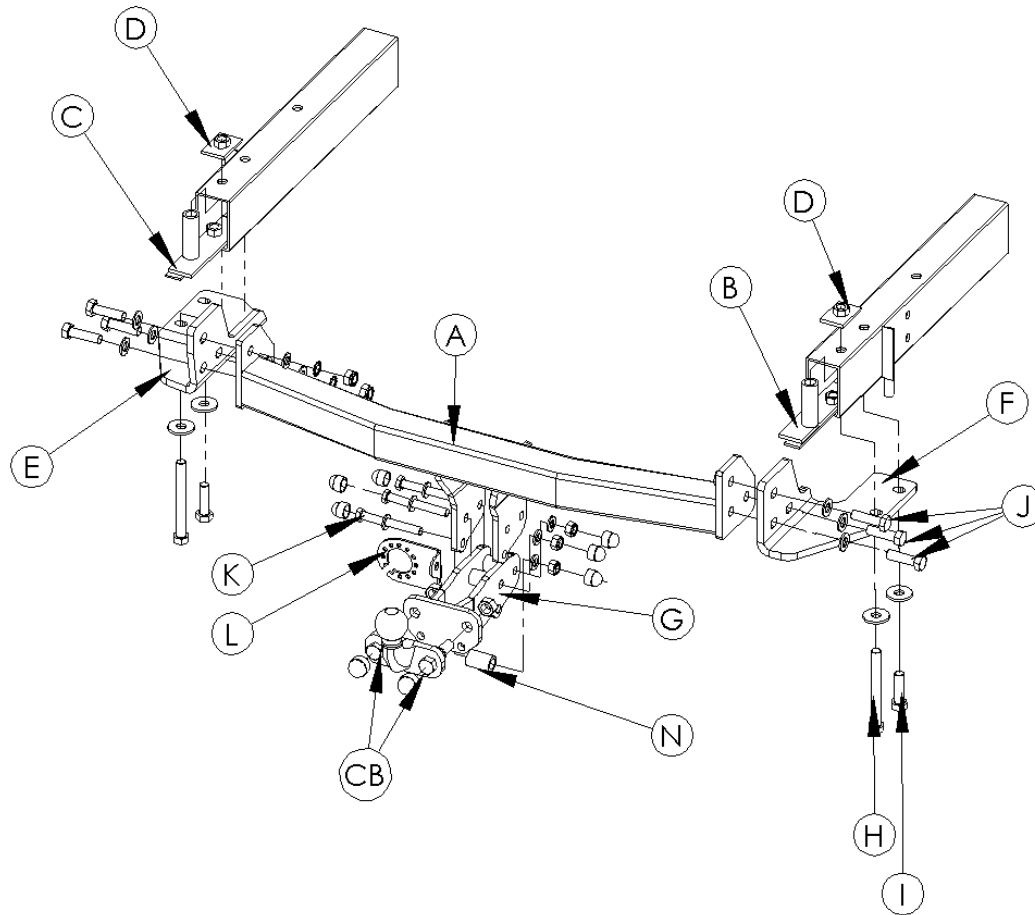

## Bumper Cut

